

Installation Instructions

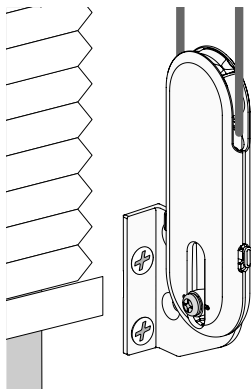

Universal Cord Tensioner

Inside Mount or Outside Mount Installations

Para Español, vea la página 17.

Getting Started

Before doing anything, you must first slide the Universal Cord Tensioner (UCT) to the bottom of the cord loop.

1. Insert a small screwdriver, punch, or awl through the screw hole at the bottom of the UCT.
2. While pressing the UCT release buttons on the sides of the UCT, move the screw hole down to release the safety mechanism.
3. Slide the UCT down to the bottom of the cord loop.
4. Install the window covering.
5. Use the following instructions to secure the UCT.

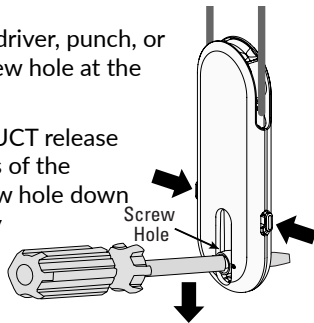

WARNING: A damaged, loose, or missing tension device poses a strangulation risk to children. Remove from use and repair or replace if tension device is damaged, loose, or missing.

CAUTION: The window covering will not operate properly unless the UCT is secured.

Required Tools

- Pencil
- Small-tip Phillips screwdriver
- Power drill with two drill bit sizes:
 - For applications not requiring wall anchors, use a $1/8$ " drill bit and drill $1\ 1/4$ " deep.
 - For applications requiring anchors, use a $7/32$ " drill bit.

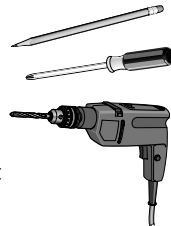

CAUTION: Use wall anchors if the mounting screws will not be secured into wood or metal. For metal surfaces, sheet metal screws are recommended.

IMPORTANT

Install the UCT in a location that minimizes access by children and pets. Locate the UCT where it will not interfere with window covering operation.

Only the supplied UCTs and UCT hardware should be used.

Wall Anchors

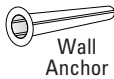

If only drywall is available for mounting, a wall anchor is required to ensure a secure attachment of the UCT. If the screw or screws can be fastened into wood or metal (even if the wood is behind drywall), a wall anchor is not necessary.

1. If no wood or metal is available to hold the screw, mark the hole position as shown in the procedures below.
2. Drill a $7/32$ " pilot hole through the drywall for each wall anchor at the locations you marked.
3. Tap each wall anchor into its pilot hole until the flange of the anchor is flush with the drywall.
4. Align the UCT or bracket holes to the anchors.
5. Attach the tensioner or bracket using the provided $1\frac{1}{2}$ " screws.

NOTE: When mounting into wood or metal, drill $1/8$ " pilot holes.

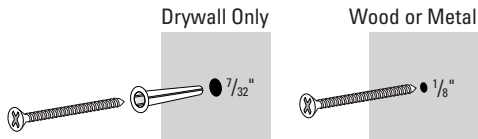

Choose a Mounting Option

The Universal Cord Tensioner (UCT) can be mounted in one of three ways:

- For outside mount (OB) products:
 - "Outside Mount" on page 6. This attaches the UCT to a bracket secured to the wall outside the window casement.
- For inside mount (IB) products, you have two choices:
 - "Inside Mount with a Bracket" on page 10. This attaches the UCT to a bracket secured to the inside of the window casement.
 - "Inside Mount without a Bracket" on page 13. This attaches the UCT directly to the inside of the window casement.
NOTE: If mounting to a textured or uneven surface, use the provided mounting bracket.

IMPORTANT: For all mounting options, locate the UCT as close to the window glass as possible to minimize accessibility by children and pets. **Be sure the UCT is not placed in the path of the bottom rail or fabric.**

Outside Mount

1. Break off the Outside Mount (OB) bracket.

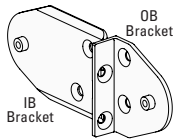

2. With the Universal Cord Tensioner (UCT) at the bottom of the cord loop, position it at the desired location.
3. Mark the wall at the notch in the UCT.

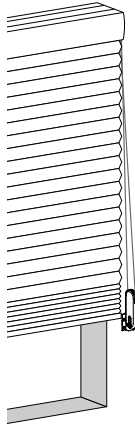
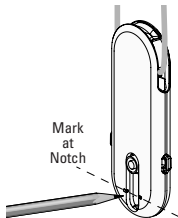

4. Hold the OB bracket with its center hole aligned with the mark and mark both screw hole locations.

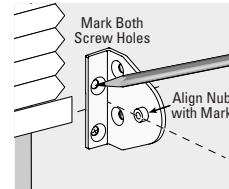

5. Drill the screw holes.
 - Determine whether or not wall anchors are required (see "Wall Anchors" on page 4) and drill either $1/8$ " pilot holes (no wall anchor) or $7/32$ " pilot holes (with wall anchor).
6. Mount the UCT bracket.
 - a. If wall anchors are required, first tap them into the pre-drilled holes.
 - b. Use a Phillips screwdriver and the longer screws provided to attach the bracket to the wall.

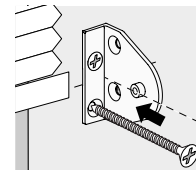

7. Attach the UCT to the bracket

- a. Press the UCT release buttons on the sides of the UCT while pulling down on the spring-loaded screw hole.

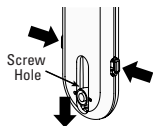

- b. Insert the nub on the inside mount bracket into the back of the screw hole in the UCT.

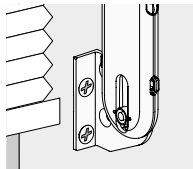

- c. Insert the small provided screw into the nub through the front of the screw hole and tighten it to secure the UCT to the bracket.

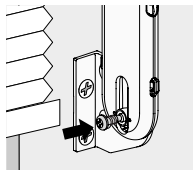

8. Ensure the cord can move freely through the UCT without engaging the lock. The center of the screw hole should be aligned with the notch in the UCT ($\pm 1/8$ ").

- If the cord does not move freely through the UCT, the cord is too tight and the UCT should be moved up.
- If the UCT locks onto the cord, the cord is too loose and the UCT should be moved down.

CAUTION: Do not pull the screw hole down to the bottom of the slot. This may cause the cord to become too tight, affecting window covering function and increasing cord wear.

Inside Mount with a Bracket

1. Break off the Inside Mount (IB) bracket

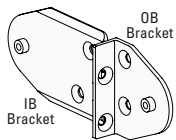

2. With the Universal Cord Tensioner (UCT) at the bottom of the cord loop, position it at the desired location.

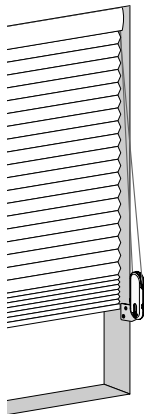

3. Mark the window casement at the notch in the UCT.

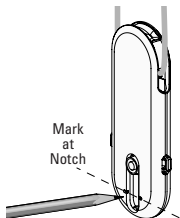

4. Hold the IB bracket with its center hole aligned with the mark and mark both hole locations.

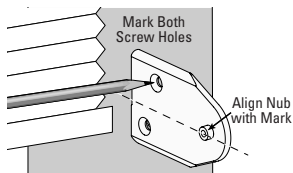

5. Drill the screw holes.

- Determine whether or not wall anchors are required (see "Wall Anchors" on page 4) and drill either a $1/8$ " pilot hole (no wall anchor) or a $7/32$ " pilot hole (with wall anchor).

6. Mount the UCT bracket.

- a. If wall anchors are required, first tap them into the pre-drilled holes.
- b. Use a Phillips screwdriver and the longer provided screws to attach the bracket to the wall.

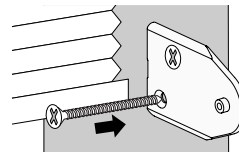

7. Attach the UCT to the bracket

- a. Press the UCT release buttons on the sides of the UCT while pulling down on the spring-loaded screw hole.

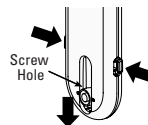

- b. Insert the nub on the inside mount bracket into the back of the screw hole in the UCT.

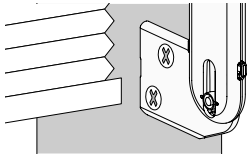

- c. Insert the small provided screw into the nub through the front of the screw hole and tighten it to secure the UCT to the bracket.

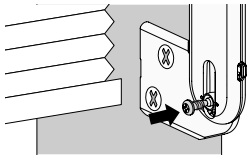

8. Ensure the cord can move freely through the UCT without engaging the lock. The center of the screw hole should be aligned with the notch in the UCT ($\pm 1/8"$).

- If the cord does not move freely through the UCT, the cord is too tight and the UCT should be moved up.
- If the UCT locks onto the cord, the cord is too loose and the UCT should be moved down.

CAUTION: Do not pull the screw hole down to the bottom of the slot. This may cause the cord to become too tight, affecting window covering function and increasing cord wear.

Inside Mount without a Bracket

NOTE: If mounting to a textured or uneven surface, use the provided mounting bracket.

1. With the Universal Cord Tensioner (UCT) at the bottom of the cord loop, position it at the desired location.
2. Mark the window casement at the notch in the UCT.

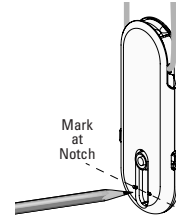
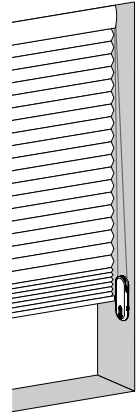

3. Mark and drill the screw hole.
 - Determine whether or not a wall anchor is required (see "Wall Anchors" on page 4) and drill either a $1/8"$ pilot hole (no wall anchor) or a $7/32"$ pilot hole (with wall anchor).
4. Mount the UCT
 - a. If a wall anchor is required, first tap the anchor into the pre-drilled hole.

- b. Insert one of the longer provided screws into the screw hole in the UCT.

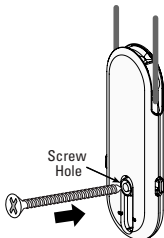

- c. Press in on the UCT release buttons and pull down on the screw hole to align the hole with the wall anchor or pilot hole.

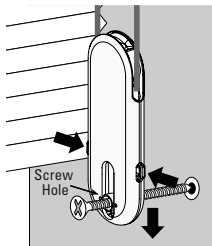

- d. Attach the UCT directly to the wall.

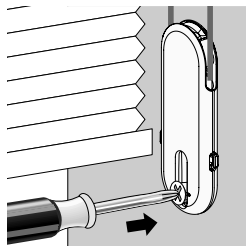

CAUTION: Do not overtighten the mounting screw. This can prevent the UCT from functioning properly and increase cord wear.

5. Ensure the cord can move freely through the UCT without engaging the lock. The center of the screw hole should be aligned with the notch in the UCT ($\pm 1/8"$).

- If the cord does not move freely through the UCT, the cord is too tight and the UCT should be moved up.
- If the UCT locks onto the cord, the cord is too loose and the UCT should be moved down.

CAUTION: Do not pull the screw hole down to the bottom of the slot. This may cause the cord to become too tight, affecting window covering function and increasing cord wear.

WARNING

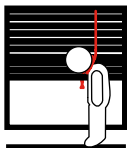

Products with a Damaged, Loose, or Missing Tension Device Pose a Strangulation Risk to Children.

This Window Blind is equipped with a Tension Device.

- Remove from use and repair or replace if tension device is damaged, loose, or missing.
- Tension device must be securely attached to wall or floor.
- Children can climb on furniture to reach cords.
- Fasteners provided with tension device may not be appropriate for all mounting surfaces.
- Use appropriate anchors for mounting surface conditions.
- Tag to be removed only by end-user.