

INSTALLATION GUIDE - OUTDOOR SUN SHADE POLE OPERATED WITH VALANCE

General Install



PART LIST

TOOLS NEEDED (not included)

Drill, tape measure, leveling device, Phillips screwdriver bit, step stool

TIPS

- We recommend two (2) people install this shade.
- Read the instructions in their entirety prior to beginning installation.
- Take an inventory of all parts prior to assembly. Pre-installed parts are not shown in the part list below.
- **The shade must be installed into studs.** If studs are not available, anchoring hardware should be used (not included). Please see your local hardware store if anchors are required.

PARTS IN THE HARDWARE BOX (not to scale)

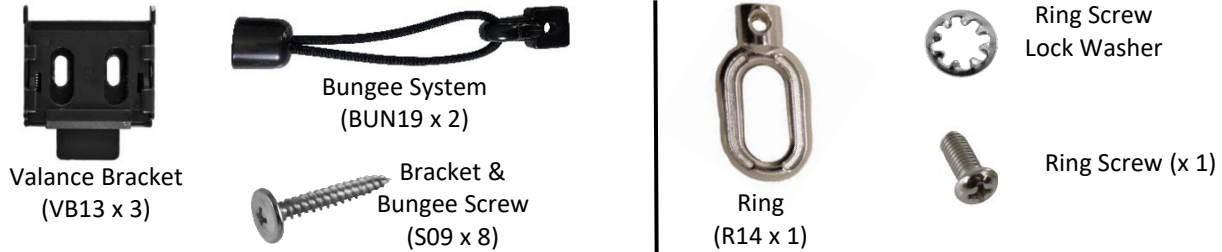

PARTS IN POLE PACKAGE (PLP21-ADJ) (not to scale)

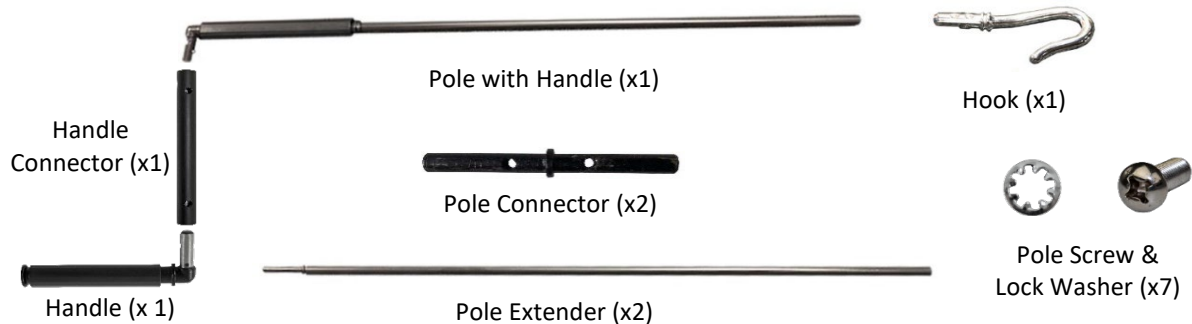

STEP 1: Remove Protective Film From Valance

Remove the anti-scratch film that covers the Valance.

STEP 2: Install Ring

Using the Ring Screw and Lock Washer provided in the pole package, attach the Ring to the Crank Mechanism (Fig A).

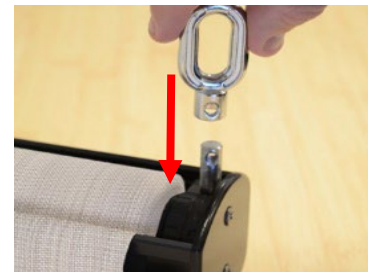

Fig A

STEP 3: Determine Your Installation Type

Your shade can be hung from a wall or a ceiling. (Fig B) illustrates a wall installation, (Fig C) illustrates a ceiling installation.



Fig B

STEP 4: Install Valance Brackets (read entire step before install)

For Wall Installations:

- If you have a ceiling that overhangs the shade, you will need to allow at least 1 in (2.5 cm) above the Valance Brackets (Fig D).
- Use the Bracket Screws to install the Valance Brackets (Fig E).
- **Make sure the plastic tabs are pointing towards the ground.**

For Ceiling Installations:

- If you have a wall/obstruction behind the shade, you will need to allow at least 1 in (2.5 cm) behind the Valance Brackets (Fig F).
- Use the Bracket Screws to install the Valance Brackets (Fig G).
- **Make sure the plastic tabs are facing forward.**



Fig C

- **Valance Brackets must be installed into wood studs.**
 - if wood studs are not available, you will need to use anchors (not included)

- Install one Valance Bracket near the center of the shade.

- Install the other two Valance Brackets near the ends of the shade.

- leave at least 2 in (5cm) of clearance from the ends of the shade

- A paper template has been provided to help align your Valance Brackets.

- make sure the template is flat and level
- temporarily adhere the template to your installation surface
- remove the template before you install your Valance Brackets

- If you are having trouble clicking the shade into place, check to make sure your Valance Brackets are aligned.

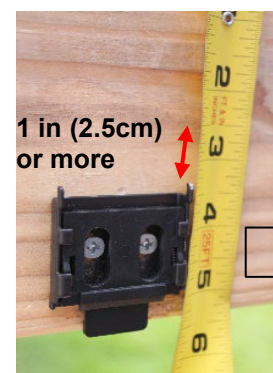

Fig D



Fig E

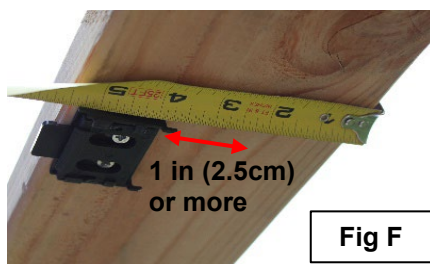

Fig F

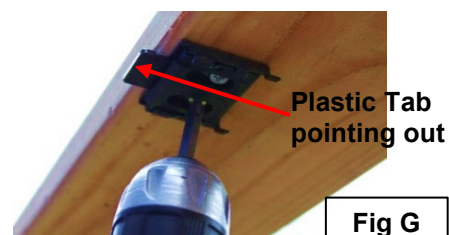

Fig G

STEP 5: Install the Shade

WALL INSTALLATION

Hook the back of the Valance on the top of the Valance Brackets (Fig H), then rotate the shade down and "click" it into place (Fig I).

CEILING INSTALLATION

Hook the top of the Valance on the back of the Valance Brackets (Fig J), then rotate the Valance upwards and "click" into place (Fig K).

IMPORTANT: Make sure your Ring is pointing down for both Wall & Ceiling Installations.

NOTE: You may need to push inwards on the plastic tabs on the Valance Brackets to help the shade "click" into place.

REMOVING YOUR SHADE

Push the plastic tabs and rotate the Valance in the



Fig H



Fig I



Fig J



Fig K



Wall Removal



Ceiling Removal

STEP 6: Assemble Pole

Before you begin, please note that your Pole can be assembled to be any of the following three (3) lengths:

- 2ft. long
- 4ft. long
- 6ft. long

Using two (2) Pole Screws and two (2) Lock Washers, attach the Handle to the Pole with Handle using the Handle Connector (Fig L).

For a 2ft. Pole:

- Attach the Hook to the Pole with Handle (Fig M).

For a 4ft. Pole:

- Attach a Pole Extender to the Pole with Handle (Fig N).

- (1) Connector Piece
- (2) Pole Screws
- (2) Lock Washers

- Attach the Hook to the Pole Extender (Fig M).

For a 6ft. Pole:

- Attach 2 Pole Extenders to the Pole with Handle (Fig N).

- (1) Connector Piece
- (2) Pole Screws
- (2) Lock Washers

- Connect the two (2) Pole Extenders to each other using a Pole Connector.

- Attach the Hook to the Pole Extender (Fig M).

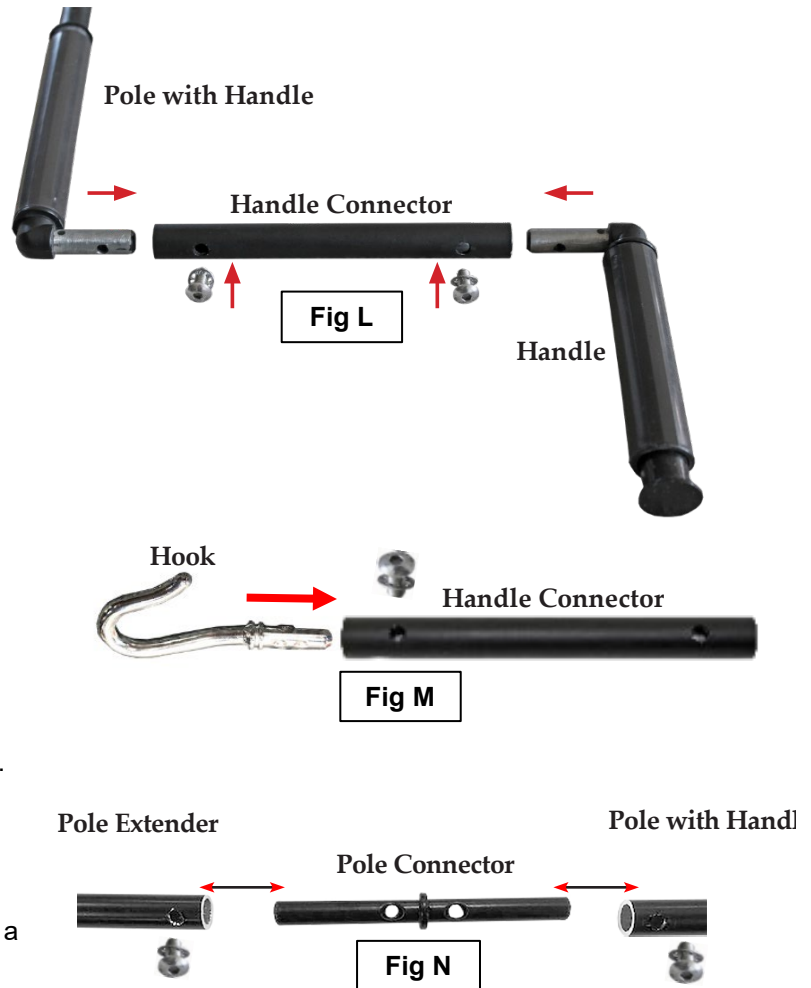

Optional Step - Install Bungee System

The shade includes two (2) Bungee Systems to secure the bottom of both sides of your shade.

Start by feeding the Bungee through the Bottom Tube Plugs (Fig O). Then insert the Bungee into the Hook and drill the Hook into a wall/post using one (1) Bracket Screw (Fig P).

To prevent fabric damage, hooks should be installed directly below the Bottom Tube Plugs and so there is equal tension on each bungee.

IMPORTANT: Your shade should be rolled up during windy conditions (up to 12mph). The Bungee System is only effective in light wind. When using your shade, we recommend leaving at least one (1) roll of fabric wrapped around the top tube.

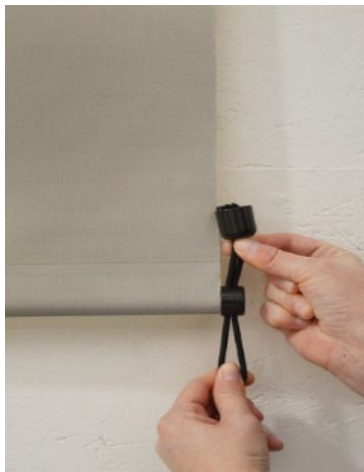

Fig O



Fig P



Bungee Install

QR Codes for Optional Steps



Reversing fabric roll
direction from backwards
to forwards



Move Ring from
right to left side



Move Ring from
front to back of
Valance

Need Help?

Installation videos are available at www.AmatriaOutdoor.com

Care & Maintenance

To clean your shade, simply rinse with water and soap, scrub with a soft brush. Note: Using bleach or an abrasive cleaner will void your warranty. Roll the shade down to air dry. Your shade should be rolled up during windy conditions. To prolong the life of your shade, we recommend leaving one (1) roll of fabric wrapped around the top tube when using your shade.

Warranty and Limitation of Liability

We will cover any manufacturing defect of the hardware for your shade for a period of two (2) years and the fabric for your shade for a period of five (5) years from the date of purchase. This warranty does not cover color fading of the hardware or fabric due to sun exposure, damage due to faulty installation (e.g., installing the shade onto an unstable surface, using shorter screws than those originally included, etc.) or misuse of the shade or hardware (e.g., leaving the shade down in high winds, exposure to chemicals/open flames, etc.). If your claim relates to a shade part, we will either help you to repair the part, or we will replace the part. If your claim relates to the fabric or valance, please contact us so we can determine if the issue can be fixed or if the shade will need to be returned. We will not pay for installation costs or to have shade parts repaired by an independent repair person. Any alterations made to your shade or hardware (e.g., cutting the fabric, making changes to the clutch assembly, etc.) will void your warranty. Proof of purchase (detailing price paid, date purchased, and place purchased) is required for all warranty claims. Important: this warranty is only valid if the shade has been purchased from an authorized reseller.